

Project: _____	AIA# _____
Item #: _____ Qty: _____	SIS# _____
Model #: _____	

## Line Chiller Racks

LCR-G, LCR-S, LCR-GE, LCR-SE

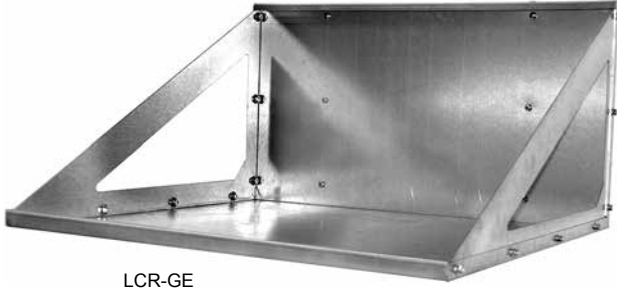

LCR-GE

### Standard Features

- All 16 gauge galvanized or stainless steel construction
- Pre-drilled mounting holes to fit Glastender line chiller models

To view cleaning and care instructions, please visit:  
[https://www.glastender.com/PDF/F-423-011\\_ss\\_clean\\_care.pdf](https://www.glastender.com/PDF/F-423-011_ss_clean_care.pdf)

### Product Details

#### LCR-S

- All 16 gauge stainless steel
- Designed for use with line chiller models BLC-1/3, BLC-1/3-2, BLC-1/2, BLC-1/2-2, BLC-3/4, and BLC-3/4-2

#### LCR-G

- All 16 gauge galvanized steel
- Designed for use with line chiller models BLC-1/3, BLC-1/3-2, BLC-1/2, BLC-1/2-2, BLC-3/4, and BLC-3/4-2

#### LCR-SE

- All 16 gauge stainless steel
- Designed for use with line chiller model BLC-1/3-E only

#### LCR-GE

- All 16 gauge galvanized steel
  - Designed for use with line chiller models BLC-1/3-E
- NOTE: Line chiller racks must be properly mounted to a structural wall.

### Dimensional Information

#### LCR-G and LCR-S

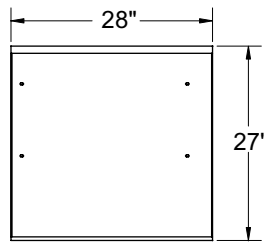

PLAN VIEW

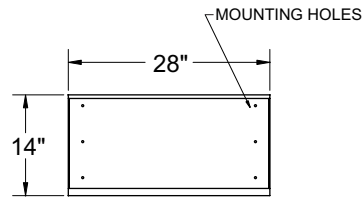

FRONT ELEVATION

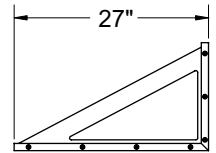

SIDE ELEVATION

#### LCR-GE and LCR-SE

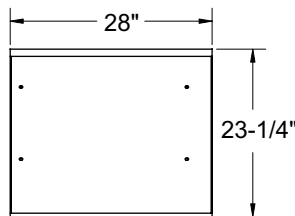

PLAN VIEW

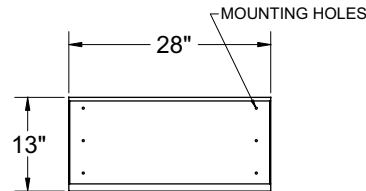

FRONT ELEVATION

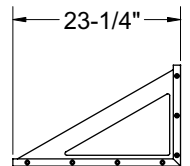

SIDE ELEVATION

Glastender, Inc. • 5400 North Michigan Road • Saginaw, MI • 48604-9780  
 989.752.4275 • 800.748.0423 • Fax 989.752.4444  
[www.glastender.com](http://www.glastender.com)

Approval/Notes:

Specifications subject to change without notice. For current specifications please visit our website.